



**STRONGER
TOGETHER**

**PRIME
EQUIPMENT GROUP**
Simple Solutions for Poultry Processing

DCC-SERIES DUAL-CASCADE COOLER

Models: DCC-Series



Dual-bank model



Single-bank model

The DCC-Series Dual Cascade Coolers for Chicken and Turkey are designed to be placed after the final picker to immediately chill the birds. This solidifies fat that has been emulsified through the picking and scalding processes, improving WOG yield up to 0.60 percent and increasing chiller efficiency down-line. Anti-microbial additives in water hit birds when skin folicles are open, reducing pre-chill bacteria counts downline.

See Prime in action: [View
www.PrimeEquipmentGroup.com/videos](http://www.PrimeEquipmentGroup.com/videos)

Viewing online?
[Click here](#)

COOLS BIRDS AFTER PICKING
CONGEALS EMULSIFIED FAT FROM
SCALDING AND PICKING
IMPROVES COOLING DOWNLINE
SINGLE- AND DUAL-BANK MODELS
AVAILABLE



PRIME ROI

CAN USE CHILLER OVERFLOW WATER TO REDUCE
H2O COOLING COSTS

IMPROVES WOG YIELD UP TO 0.60 PERCENT

REDUCES PRE-CHILL BACTERIA COUNTS DOWNLINE



2001 Courtright Road
Columbus, OH 43232 USA



Please call
+1 (614) 253-8590



Send us an email
Sales@PrimeEquipmentGroup.com



More info
PrimeEquipmentGroup.com



**STRONGER
TOGETHER**

**PRIME
EQUIPMENT GROUP**
Simple Solutions for Poultry Processing

DCC-SERIES DUAL-CASCADE COOLER

Models: DCC-Series

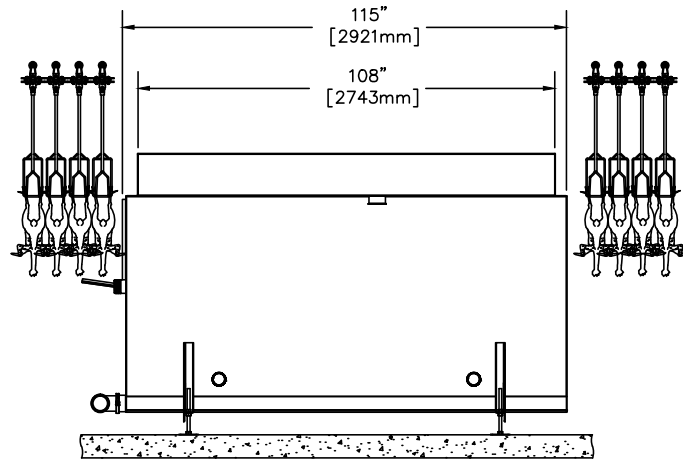
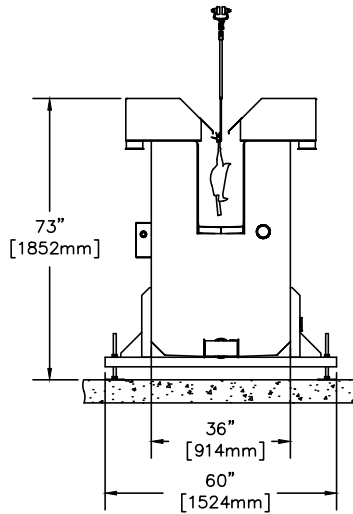

TECHNICAL SPECIFICATIONS

Electrical Requirements:	(2) 5 hp motors; 230/460/480V, 3 ph, 60 Hz, 10 amps
Water Requirements:	(1) 4" sanitary; (1) 1 1/2" pump line
Net Weight:	Single bank: 2,000 lbs.
Production Rate:	Variable with line speed
NOTE: Specifications are accurate at time of publication	